

1.0 Casino

background

- > City Council has taken a position that there will be no casinos in Toronto;
- > Exhibition Place's Board of Governors follows City Council policies;
- > Annual CNE Casino in the Better Living Centre generates net income of approximately \$555,000 to \$750,000;
- > Fung report (Waterfront, March 2002) called for a major entertainment complex at Exhibition Place/Ontario Place, with hotels and restaurants, "with or without a casino" (indicating revenues would be much higher with a casino), but did not state any preferred location.

site requirements

The following is a summary of some of the key site/facility statistics from a sample of casinos in Ontario:

Niagara Falls Casino/Gateway Project

- > 2.5 million s.f. gross building area on an 8 Ha (19.8 acre) site directly adjacent to the falls, c. \$800 million cost;
- > 9-tier, 6-storey parking garage, 3,000 spaces;
- > Theatre, 368 room hotel tower, 50,000 s.f. meeting, exhibition, conference space, 100,000 s.f. casino, 3,000 slots, 89,000 s.f. retail facility, owned by Ontario Lottery + Gaming Corp., Falls Management company;

Casino Windsor

- > 1.2 million s.f. gross building area on a 4.9 Ha (12 acre) site in downtown Windsor, \$505 million cost;
- > 7-storey adjacent parking garage, 3,000 spaces;
- > 389 room hotel in 23 storey tower, 5 restaurants, 100,000 s.f. casino, health club, spa, sports bars, lounges, gift and cigar shop owned by Ontario Lottery + Gaming Corp., operated by Park Place Entertainment Corp.;

Casino Rama

- > 400,000 s.f. gross building area, single storey (3.7 Ha, 9.1 acres excluding parking) in the country outside of Orillia;
- > 3,000 free surface parking spaces surrounding complex;
- > 300 room hotel, 9 restaurants, meeting and conference space, 192,000 s.f. casino, ballrooms, pool, entertainment centre, owned by Mnjikaning First Nation, operated by Penn National Gaming, Inc.;

Woodbine Entertainment, Toronto

- > 56,000 s.f. (building) themed gaming area on racetrack property, 1,750 slot machines, 8 restaurants, free parking. Owned by Woodbine Entertainment Group.

opportunities

- > Revenue generation for Board/City;
- > Providing ancillary services at Exhibition Place to a casino located off-site but in the vicinity may have positive impacts;
- > Casino would generate spin-off developments.

challenges

- > Contradicts City direction;
- > Limited availability of land at Exhibition Place to accommodate a competitive casino facility and its parking;
- > Conflict with need for site for other uses - CNE, Molson Indy, festivals, events;
- > Possible contradiction in the public perception of the family orientation of uses at Exhibition Place Park;
- > Would eliminate CNE Casino.

Niagara Falls Casino/Gateway Project Fact Sheet

The Niagara Falls Casino/Gateway Project that begins construction in August 2001 at a cost of approximately \$800 million, is part of a larger vision to revitalize the Niagara Falls region by transforming it into a unique, year-round tourist destination, which will draw and expand on the existing tourist base and increase visitors' length of stay.

Located on an eight-hectare site on Murray Hill overlooking the Horseshoe Falls, the casino complex-featuring a casino containing 3,000 slot machines and 150 table games, a 368-room Hyatt hotel, extensive meeting and exhibition space, a world-class retail facility, restaurants, and entertainment venues-will enhance Niagara Falls' status as a premier tourism destination.

The design of the casino and tourism components preserves the natural beauty of the Niagara escarpment and stimulates the use of existing and future regional tourism facilities. This concept reflects international trends in attraction development which are geared towards making the best use of an existing space and linking with surrounding natural and developed sites to strengthen an entire tourism area.

The complex also includes several off-site attractions including plans for a people-mover system which will connect new and existing attractions to each other and to the casino.

Following are some of the highlights of the Casino/Gateway development:

1. Casino/Entertainment/Hotel Complex

o **24-hour casino**

The casino will feature 3,000 slot machines and 150 table games. This tastefully appointed room will emanate a sense of elegance while maintaining the excitement and energy that is a hallmark of the casino experience.

o **368-room Hyatt hotel**

The 368-room hotel will feature the same superior quality and amenities found at other Hyatt Regency hotels and resorts including meeting space, restaurants and lounges and a Hyatt health spa.

o **Special event/meeting space**

50,000 square feet of meeting and exhibition space is designed to attract the growing small and medium-size exhibition and meetings market. The functional, state-of-the-art facilities are suitable for corporate meetings, conferences, fund-raising events and receptions.

o **Performing arts centre**

This versatile, multi-purpose space has a capacity for up to 1,500 guests and will serve as a live theatre and special events centre.

o **Food and beverage outlets**

The Casino complex will include a variety of restaurants offering a wide range of food and beverage options to suit all tastes. Highly themed, diverse restaurants will cater to people on the go, families or couples looking for romantic settings.

o

New retail experience

Reflecting the latest trends in retail merchandising, the shops at the Casino Complex will offer

a lively array of services, specialty stores, restaurants, lounges and entertainment experiences.

- **Hyatt Health Spa**

Guests can enjoy a full-service health spa featuring a fitness centre with whirlpool, sauna, steam and massage rooms, exercise facility and swimming pool.

- **Gateway Visitor Information Centre**

Through an innovative mix of information services, presentations, and personal service, this tourist information centre will reach millions of people each year.

2. Off-Site Attractions

- **River Country: Marineland Expansion**

Falls Management Company will assist in the development of River Country, a major theme park concept, proposed as an addition to Marineland. River Country, a celebration of life and nature in and around rivers, will feature a number of key attractions. These include: a thrilling Wild River Raft Ride; an idyllic lake with a 650-metre long white sand beach; paddleboat rentals; a picnic pavillion; a children's creative play area devoted to water activities; River Town, a quaint village entertainment and food services area; and an old fashioned steam engine train ride.

- **Amphitheatre**

This year-round, 12,000-seat off-site indoor/outdoor concert facility is a first-class venue capable of attracting some of the world's top entertainers.

- **People Mover**

Falls Management Company is participating with the City of Niagara Falls, the Niagara Parks Commission, provincial and federal governments and other key stakeholders to help make the people mover project a reality. The people-mover will serve as a major transportation linkage enabling more than five million riders to access the Casino/Gateway project and other attractions in a safe, efficient and convenient manner. An attraction in its own right, the people-mover will bring significant tourism benefits to the city, and will become one of the internationally recognized symbols of Niagara Falls.

Return to PERMANENT CASINO NIAGARA COMPLEX SITE PREPERATIONS Document

Niagara Falls Casino / Gateway Project

Proposed Permanent Casino to be located at the corner of Murray Hill and Buchanan Avenue

To view what type of transportation that Niagara Falls will provide to go directly to the new Casino, please go to the [People Mover's Executive Summary](#)

Quick Facts: as of September 12, 2000

- 3,000 slot machines
- 150 gaming tables
- 17,790 square-metre (191,489.96 sq.ft.) casino
- 368 - room hotel tower
- 8,314 square-metre (89,491.15 sq.ft.) entertainment and retail shops
- 1,500 seat theatre plus an additional 3,437 square metres (36,995.56 square feet) of entertainment space
- 4,450 square-metre (47,899.40 sq.ft.) exhibit hall
- nine-tier, six-storey parking garage with room for 3,000 cars
- esthetically pleasing, with manicured walkways, ivy-covered walls, gardens and fountains surrounding the eight-hectare complex
- a glass dome is the centrepiece of the design from the exterior, arching over the main entrance at Buchanan Avenue and Murray Street
- from the dome, a galleria walkway stretches back towards the falls, with the major components of the complex branching off from the hallway.
- at the end, overlooking the Horseshoe Falls, is a rotunda, to house a food court and other shopping venues
- Joint Venture Architects: Zeidler Roberts Partnership/Architects, (Partner-in-Charge: Eberhard Zeidler) and Bregman + Hamann Architects, (Partner-in-Charge: Tonu Altosaar)
- construction is slated to begin in spring 2001, with a 30-month construction period
- off-site attractions, like a planned amphitheatre seating as many as 15,000 people in the summer, could be opened a year before the casino
- the casino will create 5,000 permanent full-time and part-time direct jobs, with approximately 5,000 indirect jobs
- the complex could cost upwards of \$800 million, all financed by the private sector
- the interim property, Casino Niagara, located at 5705 Falls Avenue (<http://www.casinoniagara.com>) continues to operate as a successful attraction and is an economic catalyst for new developments in Niagara Falls

For further details, please contact:

Serge Felicetti
Director of Business Development
City of Niagara Falls
4310 Queen Street
P.O. Box 1023
Niagara Falls, Ontario L2E 6X5
905-356-7521 ext. 5102
905-357-9293 fax
sfelicet@city.niagarafalls.on.ca

Return to most recent [Media Release](#)

Disclaimer: The statistics provided above are a compilation of several sources including recent newspaper articles.

Facts & Features

Luxury Suites

Hotel Sales & Catering Office: Phone: (705)238-5900 • Fax: (705)329-5800
RR 6, P.O. Box 178, Rama, ON • L0K 1T0

289 Deluxe Suites all featuring:

- Individual Gas Fireplaces
- Two Phone Lines with Data Ports
- Voice Mail
- On Demand In-Room Movies, Nintendo & High Speed Internet Surfing
- 31" Colour Television
- In-Room Safes
- Iron & Ironing Boards
- Hairdryers & Make-up Mirrors
- Individual Climate Control
- Separate Glass Showers & Soaker Tubs
- Marble Bathrooms
- 2 Club Floors featuring Upgraded Guest Suites & Amenities
- Variety of One Bedroom Suites

Entertainment

- Gaming Casino with over 2,100 Slot Machines & more than 110 Gaming Tables - featuring Roulette, Blackjack, Big Six, Baccarat, Mini Baccarat, Craps, Poker & more, 24 hours a day!
- Off-Track Betting
- 5,000 Seat state-of-the-art Entertainment Centre featuring Big Name Acts every week

Conference Services

- Hotel Sales & Catering Department to assist in all arrangements & coordination
- 11 Meeting Rooms
- Superb Shipping & Receiving Facilities
- Complete on-site Audio Visual Services
- Banquet Menu Selection & Special Details arranged by Hotel Sales & Catering Department

Health club & spa

- Complete Indoor Pool & Exercise Room with Saunas, Hot Tubs & Steam Rooms featuring a Roof Top Garden located on the third level
- Exquisite Spa featuring Massage, Aesthetics, Manicures, Pedicures & Facials



hotelsales@casinorama.com • www.casinorama.com

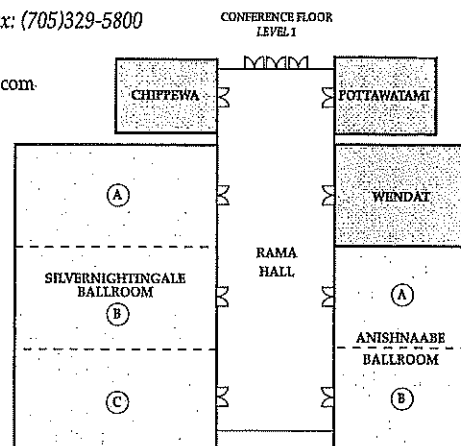
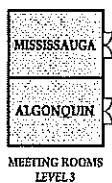

MAXIMUM CAPACITIES	DIMENSIONS (w x l)	TOTAL SQ. FT.	CLASSROOM	U-SHAPE	BANQUET (RND'S 10)	RECEPTION	THEATRE	BOARDROOM
Silvernightingale Ballroom	100 x 66	6600	440	---	500	680	720	---
Silvernightingale AB/BC	67 x 66	4422	240	---	300	575	480	---
Silvernightingale A	33 x 66	2178	120	57	130	225	180	---
Silvernightingale B	34 x 66	2244	120	57	130	225	180	---
Silvernightingale C	33 x 66	2178	120	57	130	225	180	---
Rama Hall Prefunction	39 x 125	4875	---	---	---	500	---	---
Anishnaabe Ballroom	66 x 44	2904	144	52	200	300	320	---
Anishnaabe A	33 x 44	1452	72	33	100	150	132	28
Anishnaabe B	33 x 44	1452	72	33	100	150	132	28
Wendat	33 x 44	1452	72	33	100	150	132	28
Pottawatami	25 x 33	825	32	20	40	85	77	20
Chippewa	24 x 33	792	32	18	40	80	70	20
Mississauga	22 x 31	682	24	20	20	50	63	12
Algonquin	22 x 31	682	24	20	20	50	63	12

Food & Beverage

- **St. Germain's Steakhouse:** Classic Steakhouse offering outstanding service & fine food
- **The Weirs:** Casual dining in a relaxed atmosphere
- **Firestarter Lounge:** Cozy yet elegant. Relax and unwind, located near the hotel lobby
- **Willows:** Enjoy authentic Cantonese Cuisine
- **Couchiching Court Buffet:** All-day dining with a sumptuous all-you-can-eat buffet
- **Rinaldo's:** Dining at it's finest, in a Tuscan atmosphere with the tastes of Italy
- **Dream Catcher Sports Lounge:** Catch the excitement with great food, great sports and off-track betting
- **Legends Food Court:** Great for a quick, light snack
- **Noodle Bar:** Authentic Cantonese Noodles & Soup
- **In-Suite Dining:** Available 24 hours

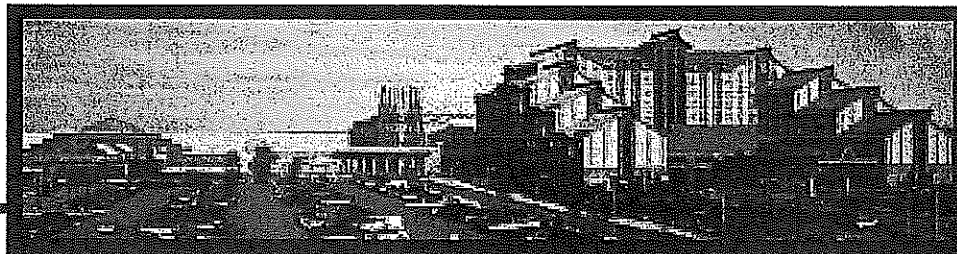

operated by: PENN NATIONAL GAMING & HOTEL

Facts & Features

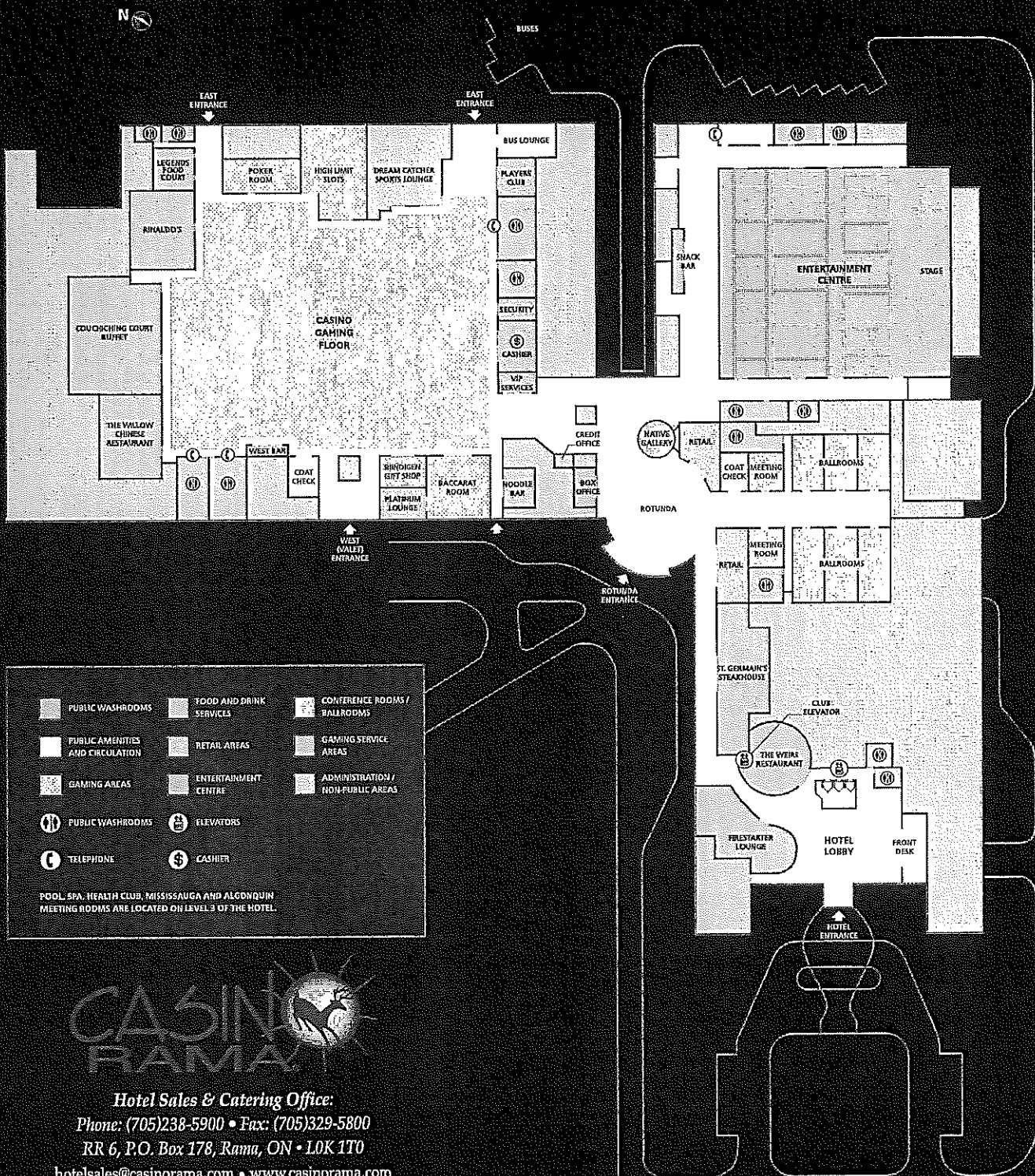

- | | | |
|----------------------------------|-------------------------|-----------------------------------|
| PUBLIC WASHROOMS | FOOD AND DRINK SERVICES | CONFERENCE ROOMS / BALLROOMS |
| PUBLIC AMENITIES AND CIRCULATION | RETAIL AREAS | GAMING SERVICE AREAS |
| GAMING AREAS | ENTERTAINMENT CENTRE | ADMINISTRATION / NON-PUBLIC AREAS |
| PUBLIC WASHROOMS | ELEVATORS | |
| TELEPHONE | CASHIER | |

POOL, SPA, HEALTH CLUB, MISSISSAUGA AND ALGONQUIN MEETING ROOMS ARE LOCATED ON LEVEL 3 OF THE HOTEL.



Hotel Sales & Catering Office:
 Phone: (705)238-5900 • Fax: (705)329-5800
 RR 6, P.O. Box 178, Rama, ON • L0K 1T0
hotelsales@casinorama.com • www.casinorama.com



